

## VC9040 DOBRADIÇA PIVOTANTE

206000911  Inox



 100 Kg

Pivot Superior



Pivot Inferior

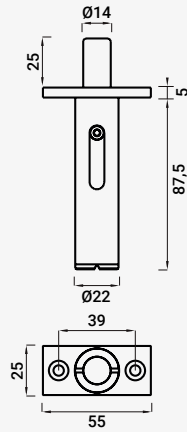

## VC9146 ESPELHO DE ACESSO

 Latão

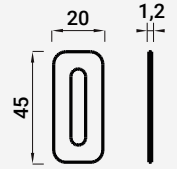

206000912  Cromado

206000913  Aço Inox Satinado

206000914  Cromado Satinado

206000915  Titan

206000916  Niquelado Pérola

206000917  Preto

### MONTAGEM: Abertura na face interior da porta Opção 1

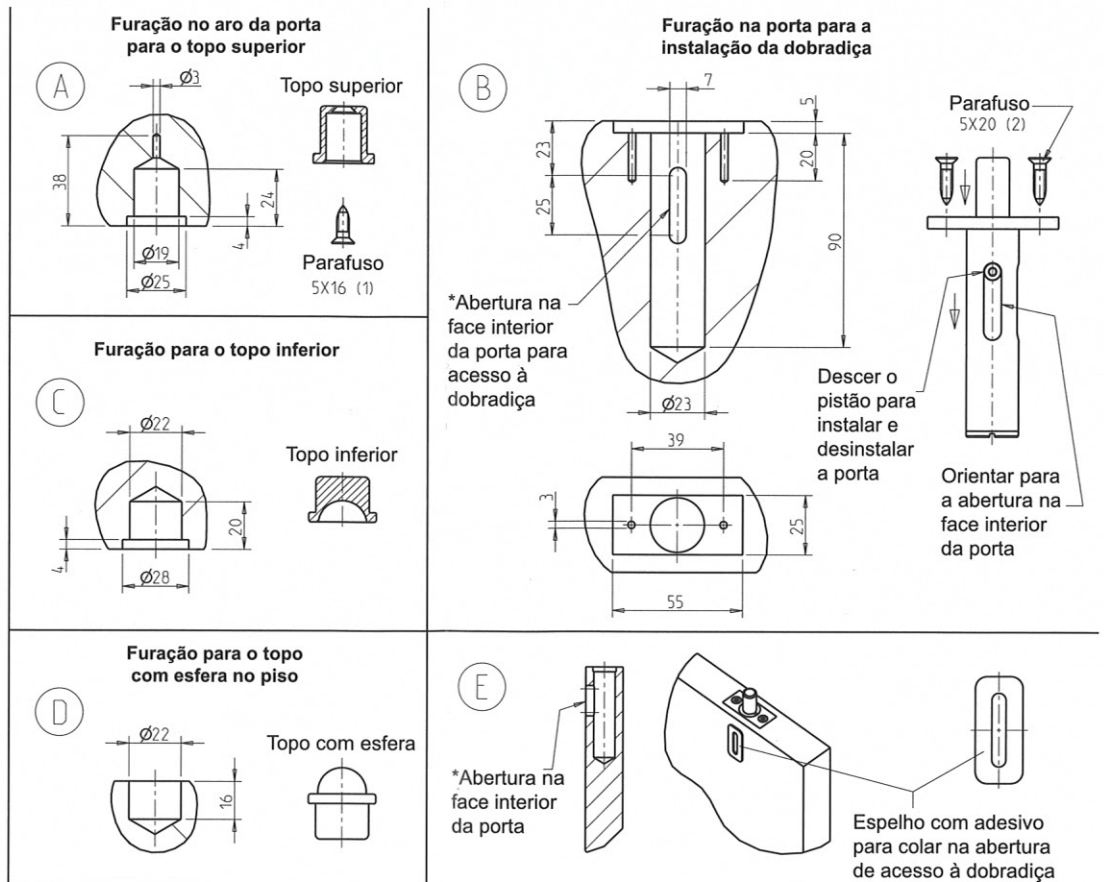
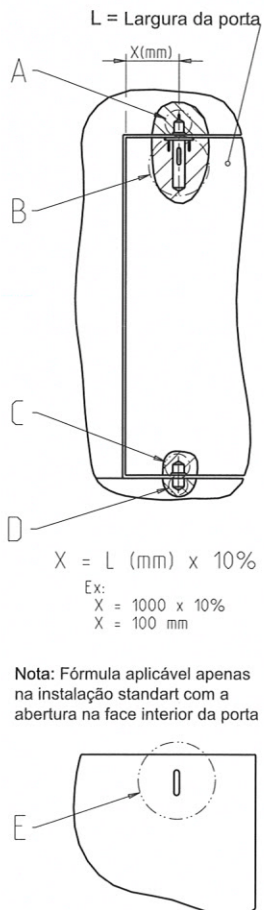

## MONTAGEM: Abertura na zona lateral da porta Opção 2

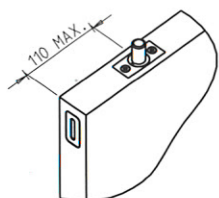

Nota: Ultrapassando a distância recomendada, fica limitado o acesso à dobradiça

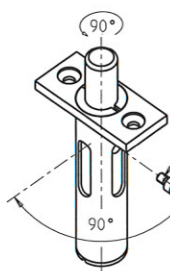
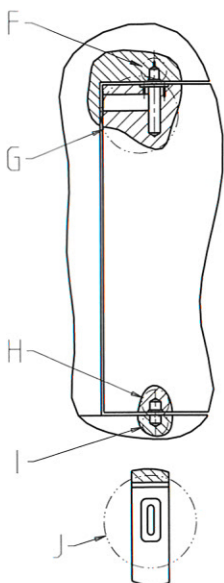

Se pretender aplicar a dobradiça na zona lateral da porta: Desaperte o parafuso da posição inicial, rode o pistão 90° e volte a apertar o parafuso na nova posição

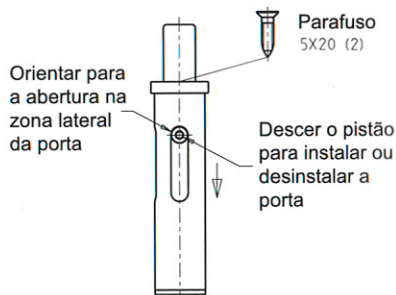

### Furação no aro da porta para o topo superior

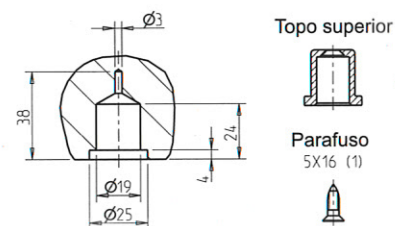

### Furação na porta para a instalação da dobradiça

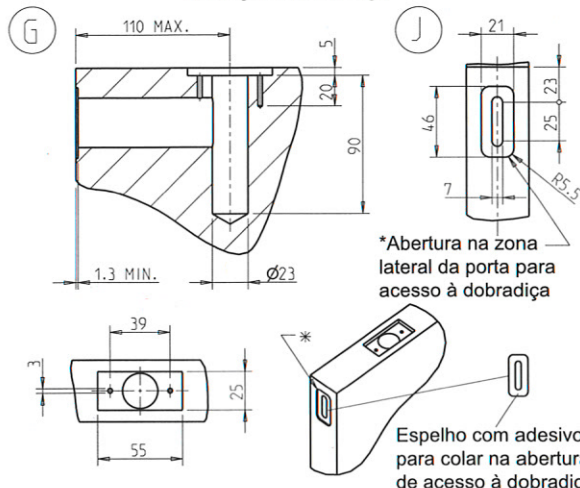

### Furação para o topo inferior

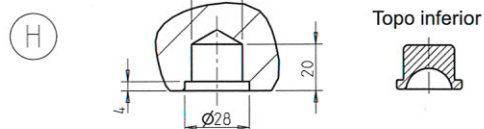

### Furação para o topo com esfera no piso

